

**KEMET Part Number: USEQFSEA50L180**  
(USEQFSEA50L180)

KEMET, QFS, Flame Detection, SMD, Infrared, Small SMD Package, 12C Communication Compatible

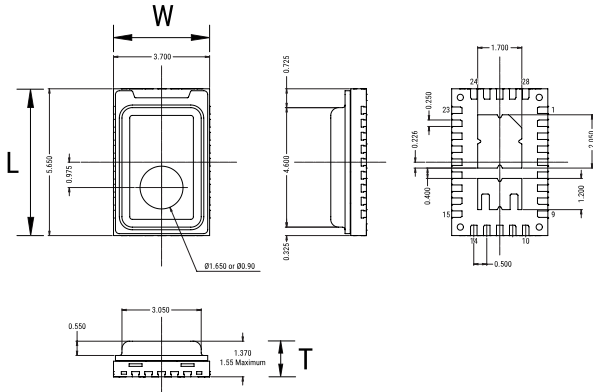

**Dimensions**

<b>L</b>	5.65mm NOM
<b>W</b>	3.7mm NOM
<b>T</b>	1.55mm MAX

**Packaging Specifications**

<b>Packaging:</b>	T&R, 178mm
<b>Packaging Quantity:</b>	800
<b>Weight:</b>	70 mg

**General Information**

<b>Series:</b>	QFS
<b>Type:</b>	Flame Detection
<b>Style:</b>	SMD
<b>Description:</b>	12C
<b>Features:</b>	Small SMD Package, 12C Communication Compatible
<b>RoHS:</b>	With Exemptions
<b>REACH:</b>	SVHC (PZT – CAS 12626-81-2)
<b>SCIP Number:</b>	f8c5f819-a3bd-41c4-887e-bd5dc8c5edf
<b>Qualifications:</b>	REACH
<b>MSL:</b>	3

**Specifications**

<b>Temperature Range:</b>	-40/+85°C
<b>Power Supply Voltage:</b>	1.75 - 3.6 V
<b>Current:</b>	1 - 23 uA (Supply Current, Typical)
<b>Miscellaneous:</b>	Human motion rejection. Sensor Type: Single.
<b>D*:</b>	$2.5 \times 10^8 \text{ cm} \sqrt{\text{Hz}} / \text{W}$
<b>NEP:</b>	$2.7 \times 10^{-10} \text{ W}/\sqrt{\text{Hz}}$
<b>Time Constant:</b>	10ms (10-20 Hz peak)
<b>Field of View:</b>	90 degrees
<b>Element Size:</b>	0.64mm x 0.64mm
<b>Filter Aperture:</b>	d = 1.65 mm
<b>Filter:</b>	5 um long pass (human motion rejection)