

KEMET Part Number: SS-430L-W
(USES430LW00000)

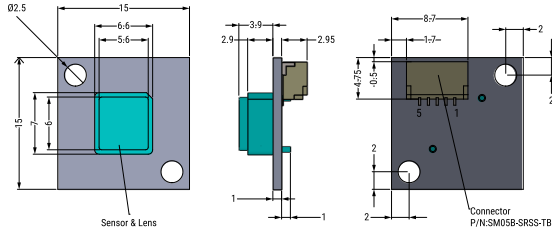

KEMET, SS, Proximity, SMD, Pyroelectric Infrared, Detection Up To 3.5 Meters



Dimensions	
L	15mm NOM
W	15mm NOM

Packaging Specifications	
Packaging:	Tray, Box
Packaging Quantity:	200
Component Weight:	800 mg

General Information	
Series:	SS
Type:	Proximity
Style:	SMD
Description:	Sensor Module with Lens: White
Features:	Detection Up To 3.5 Meters
RoHS:	With Exemptions
REACH:	SVHC (PZT – CAS 12626-81-2)
SCIP Number:	b06085bf-9f10-4ccb-b57e-2d52aeb75c2d
Qualifications:	REACH
Field of View:	Horizontal +/- 37 degree, Vertical +/-28 degrees

Specifications	
Temperature Range:	-20/+60°C
Voltage DC:	3 VDC (Output, Detection), 0.0 VDC (Output, Non-Detection)
Power Supply Voltage:	3.5 -5.5 VDC
Current:	800 uA MAX (Consumption)
Miscellaneous:	Detection Output Voltage: 0.2 Seconds. Warm Up Time: 30 Sec (MAX).

Statements of suitability for certain applications are based on our knowledge of typical operating conditions for such applications, but are not intended to constitute - and we specifically disclaim - any warranty concerning suitability for a specific customer application or use. This Information is intended for use only by customers who have the requisite experience and capability to determine the correct products for their application. Any technical advice inferred from this Information or otherwise provided by us with reference to the use of our products is given gratis, and we assume no obligation or liability for the advice given or results obtained.

